

COLLAPSIBLE TRIPOD

Another innovative product to OCC's line of modular, deployable reels and accessories.



Optical Cable Corporation (OCC) introduces the Collapsible Tripod, a new member of the Modular Advanced Reel System (MARS) family of fiber optic reels and accessories. In today's world, space and weight are critical attributes to consider when purchasing deployable cabling systems. OCC's new Collapsible Tripod meets both these criteria with a lightweight and compact design. In minutes, the Collapsible Tripod assembles into a fully functional cable deployable system that can support MARS 100M, 300M and 500M reels.

Features & Benefits:

- Interchangeable axles are available in MARS 100M, 300M, 500M reel options
- Compact design - collapsed tripod measures 18.8"W x 4.7"H x 5.9"D (477.52mm x 119.38mm x 149.86mm)
- Lightweight footprint - weighs only 9.5 lbs (4.3 kg), yet supports up to 40 lbs. (18.2 kg)
- Constructed of sturdy 11 gauge steel for rugged durability
- Integrated brake prevents reel spinning during cable deployment as well as movement of installed reels in transit
- Retractable handle allows for ease of transport

Applications:

- Mobile Emergency Communications Systems
- Mobile Tactical Shelters
- U.S. Army, Navy, and Marine Corps Military Tactical Deployments
- Broadcast
- Deployable Communications



COLLAPSIBLE TRIPOD



Another innovative product to OCC's line of modular, deployable reels and accessories.

Mechanical and Environmental Performance

| PARAMETER | SPECIFICATION | RANGE |
|------------------------------|--|-----------------------|
| Temperature-Humidity cycling | EIA/TIA-455-5C, 240 hours | -40°C to 85°C, 95% RH |
| Storage testing | EIA/TIA-455-5C | -40°C to 85°C |
| Vibration | Frequency = 10 to 33Hz, Amplitude = Horizontal 0.020", Vertical = 0.030", collapsed position | Duration = 3 hours |
| Drop test | 3.5 ft. drop onto concrete floor, full load - 40 lbs. | 3 sides |
| Weight | | 9.5 lbs (4.3 kg) |

Dimensions

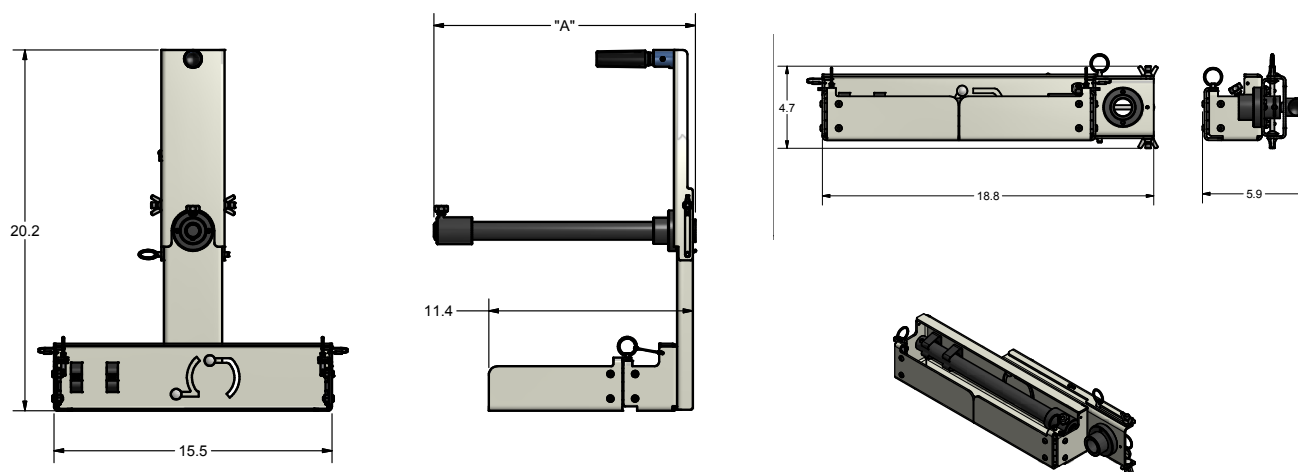

Ordering Information:

| PART NUMBER | DESCRIPTION |
|-------------|--------------------------|
| AFB-0100-Y | Collapsible Tripod, 100M |
| AFB-0300-Y | Collapsible Tripod, 300M |
| AFB-0500-Y | Collapsible Tripod, 500M |

Replace "Y" with color code: B = black, G = carc green, T = desert tan



Shown with connector I/O access panel integrated Rio Reel



CORPORATE HEADQUARTERS

5290 Concourse Drive | Roanoke, VA 24019 | USA

Phone: +1-540-265-0690 | 800-622-7711

Fax: +1-540-265-0724