

1. Remove 50-60 mm (approx. 2-2.5 in.) of cable sheath and polyester tape taking care not to damage the conductor insulation.
2. Press the cable into the slot at the back of the jack; align the sheath to the base of the IDC blocks.
3. Initially insert Blue pair in IDC slots 1, 2 and Green pair in IDC slots 5, 6.
4. Ensuring that the twist in the wire is maintained up to the IDC slot, insert Brown pair in IDC slots 7, 8 and Orange pair in IDC slots 3, 4.
5. When wires are correctly positioned, use the impact tool set to LOW to make final connection.
6. Snap completed jack into the faceplate.

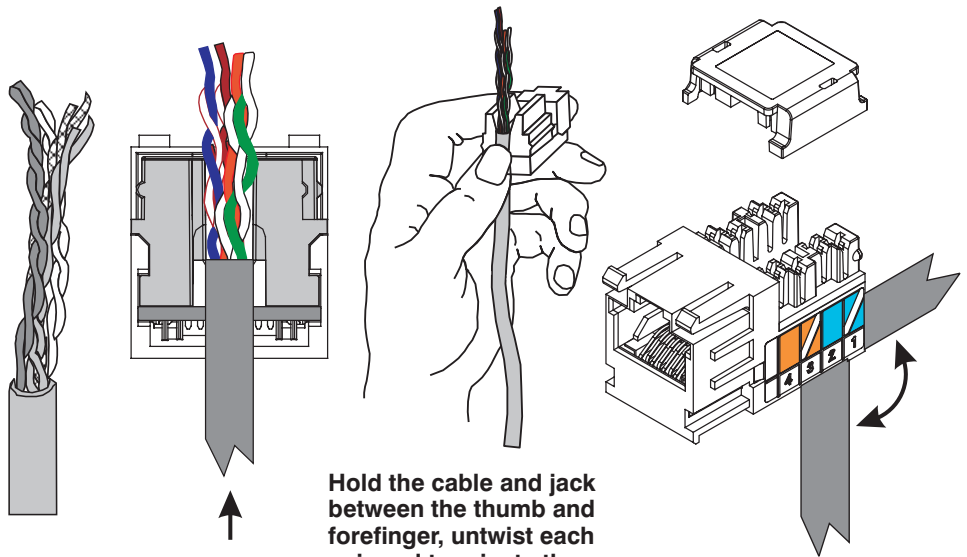

Hold the cable and jack between the thumb and forefinger, untwist each pair and terminate them in the order shown in the Termination Table on back.

NOTE: Stuffer cap may be used to seat contacts in IDC slots if termination tool is not available.

STEP 1

STEP 2

STEP 3

TERMINATION TABLE

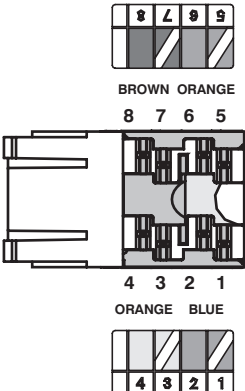
IDC REAR CONNECTOR TERMINAL	WIRE COLOR	JACK TERMINAL LAYOUT (TOP VIEW)
1	WHITE / BLUE	
2	BLUE	
3	WHITE / ORANGE	
4	ORANGE	
5	WHITE / GREEN	
6	GREEN	
7	WHITE / BROWN	
8	BROWN	

4 KEYED BEZEL CONFIGURATIONS

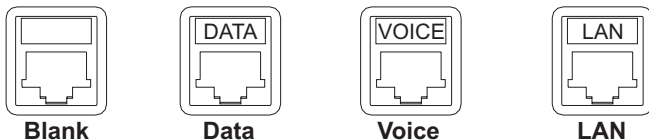

12 AVAILABLE COLORS

- | | | |
|---------------------|-----------|---------------|
| 00 Electrical Ivory | 05 Blue | 09 Yellow |
| 01 Office White | 06 Gray | 10 Purple |
| 02 Black | 07 White | 18 Light Blue |
| 03 Red | 08 Orange | 19 Brown |

