

SPECIFICATIONS

FEATURES/MATERIALS:

- LOCKING CUSTOM COLOR/ICON BEZELS PROVIDE DISTINCTIVE JACK IDENTIFICATION.
- CUSTOM BEZELS ARE AVAILABLE IN A WIDE VARIETY OF COLORS AND ICONS.
- BEZELS ARE CONSTRUCTED OF HIGH IMPACT SELF EXTINGUISHING, RATED 94V-0

TO ORDER OPTIONAL COLOR BEZELS, REPLACE "XX" WITH COLOR CODE.
EXAMPLE: APBLK02 = BLACK

BEZEL COLOR CHART

00 ELECTRICAL IVORY	06 DATA GRAY
01 OFFICE WHITE	07 WHITE
02 BLACK	08 ORANGE
03 RED	09 YELLOW
04 GREEN	10 PURPLE
05 BLUE	11 BROWN

PROPOSED EIA/TIA 606 COLOR CODED IDENTIFICATION SYSTEM

TERMINATION TYPE	COLOR	SUPERIOR COLOR CODE
DEMARCATON POINT	ORANGE	08
NETWORK COMMUNICATIONS	GREEN	04
COMMON EQUIPMENT	PURPLE	10
FIRST LEVEL BACKBONE	WHITE	07
SECOND LEVEL BACKBONE	GRAY	06
STATION	BLUE	05
INTERBUILDING BACKBONE	BROWN	11
MISCELLANEOUS	YELLOW	09
KEY TELEPHONE SYSTEMS	RED	03



UNCONTROLLED COPY

UNLESS OTHERWISE SPECIFIED DIMENSIONS ARE IN INCHES
TOLERANCES:
FRACTIONS $\pm 1/32$ "
ANGLES $\pm 1/2$ "
3 PLACE DECIMALS $\pm .005$ "
2 PLACE DECIMALS $\pm .01$ "

THIS DRAWING AND THE DESIGN SHOWN ARE THE PROPERTY OF OPTICAL CABLE CORPORATION AND MAY NOT BE USED AS THE BASIS FOR MANUFACTURE OR SALE WITHOUT SPECIFIC WRITTEN PERMISSION OF OPTICAL CABLE CORPORATION.

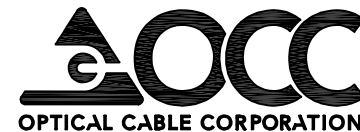

5290 Concourse Drive
Roanoke, VA 24019
Phone: 800-622-7711
Fax: 540-265-0724
www.occfiber.com



THIRD ANGLE PROJECTION

CRITICAL DIMENSION CODE
 (F) = FUNCTION
 (M) = MATING
 (A) = AUDIT

MATERIAL CATEGORY: THERMOPLASTIC
COLOR SPECIFICATION
OCC DRAWING# 100004

FINISH
MT1055-5(MED EDM)
POLISHED (UNLESS OTHERWISE INDICATED)

DRAWN BY	D.A.HOLBERT	DATE	9/28/01
CHECKED BY	R.B.SMITH	DATE	4/21/02
ENGINEER	J.YANIK	DATE	9/28/01
APPROVED	H.JOHNSON	DATE	2/22/10
PREVIOUS DWG			
NEXT DWG			

DWG TITLE
ADAPTER PLUG KIT, BLANK

SIZE
A

DWG NO.

C104797

REV
A

SCALE NONE

SHEET 1 OF 1

REVISIONS

REV	SHT	DESCRIPTION	DATE	ECN	CHECKED
A	ALL	RELEASE NEW	9/28/01	NEW	RBS

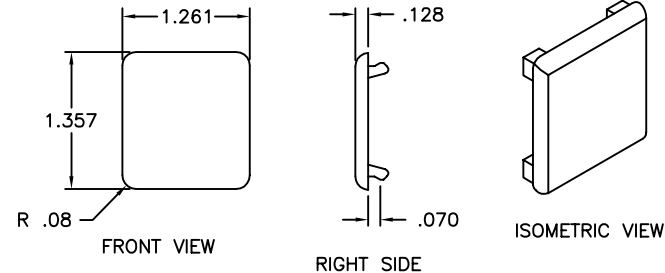

APBBLKXX	ADAPTER PLUG, BULK, BLANK, "COLOR"
APBLKXX	ADAPTER PLUG, BLANK, "COLOR"
OCC PART NO.	DESCRIPTION

FILENAME C104797A.DWG