

FEATURES:

- ENCLOSURE BODY AND SLIDING TRAY CONSTRUCTED OF 18 GA STEEL; POWDER COATED BLACK.
- METAL DIN RAIL CLIP MOUNTABLE ON REAR AND RIGHT SIDE OF ENCLOSURE. DESIGNED FOR 35MM DIN RAILS ONLY.
- LEGACY PLASTIC DIN RAIL CLIPS AVAILABLE, BUT SOLD SEPERATELY. (ACCOMMODATE 35MM AND 32MM DIN RAILS)
- HARDWARE KIT FEATURES HOOK AND LOOP STRIPS AND MAGNETIC SPLICE HOLDER COMPONENTS FOR FIBER MANAGEMENT.

"OPTICAL CABLE CORPORATION (OCC) RESERVES THE RIGHT TO REVISE ANY AND ALL DESIGN SPECIFICATIONS."
UNCONTROLLED COPY

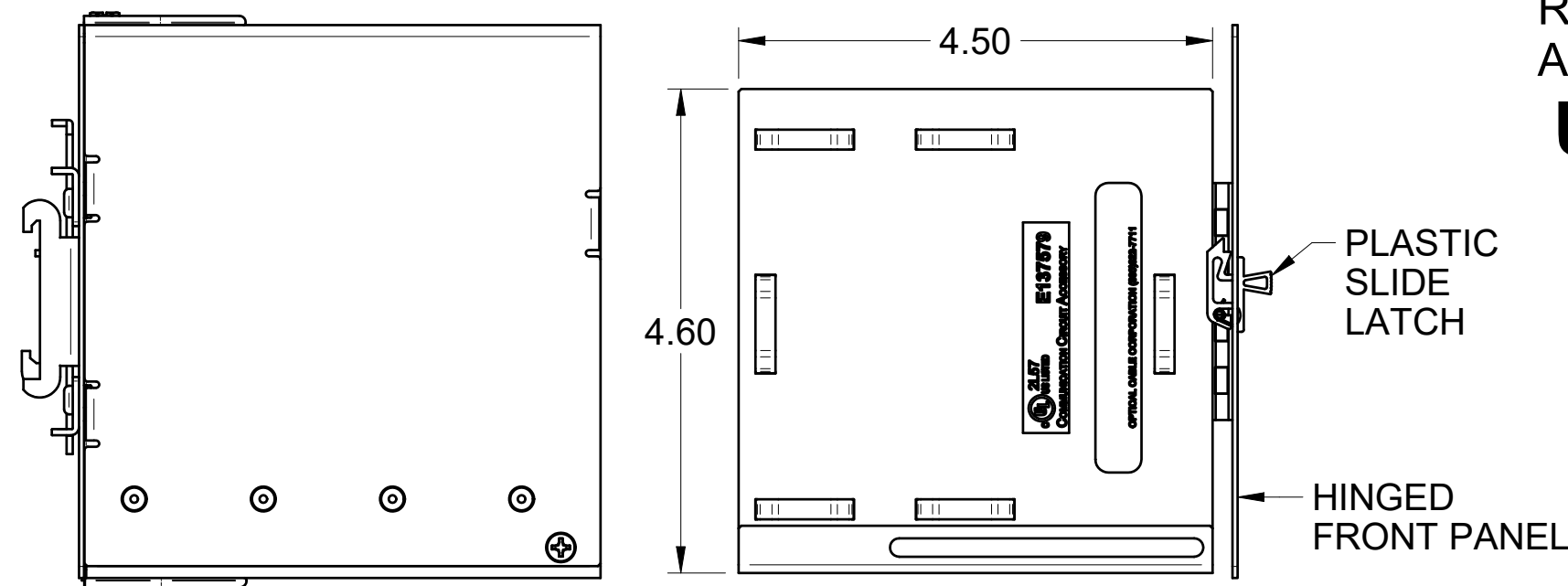

SLIDING TRAY OUT

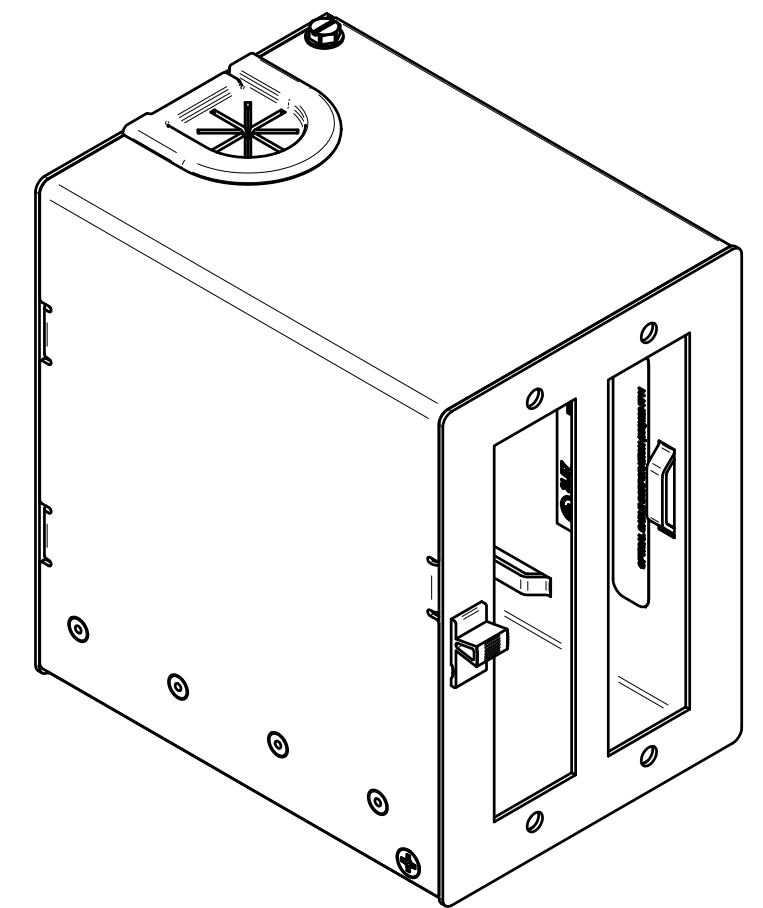

FRONT ISOMETRIC VIEW

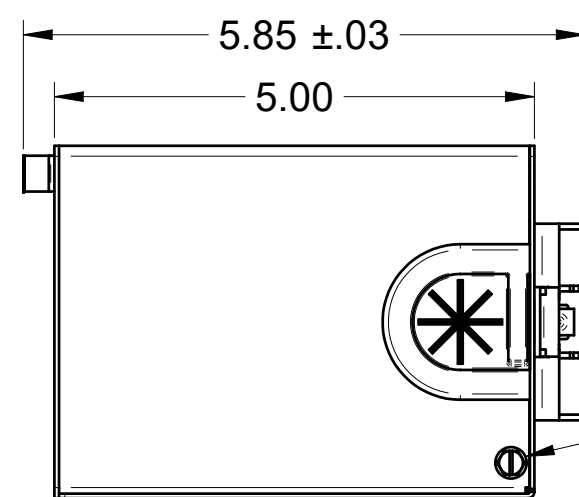

TOP VIEW

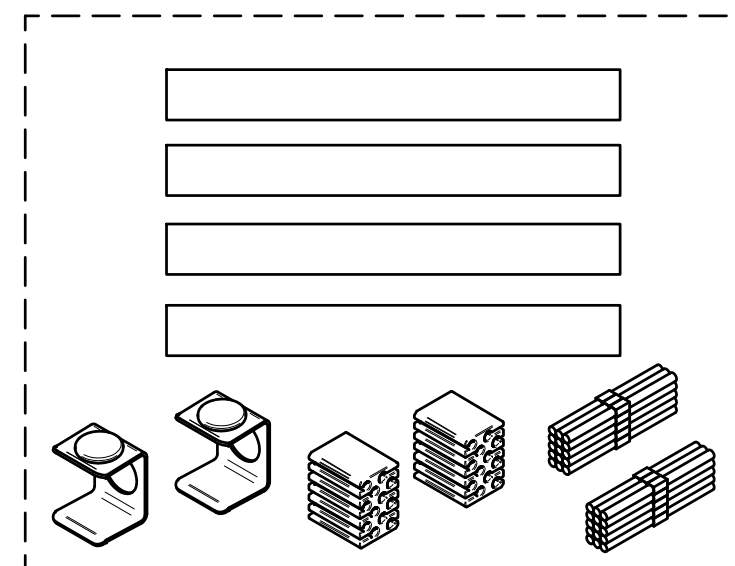

INCLUDED HARDWARE KIT

- 1/2" X 4-1/2" HOOK AND LOOP STRIPS (4X)
- MAGNETIC SPLICE HOLDER CLIP (2X)
- ELASTIC SPLICE HOLDER 12 POS. (2X)
- 40MM SPLICE SLEEVES (28X)

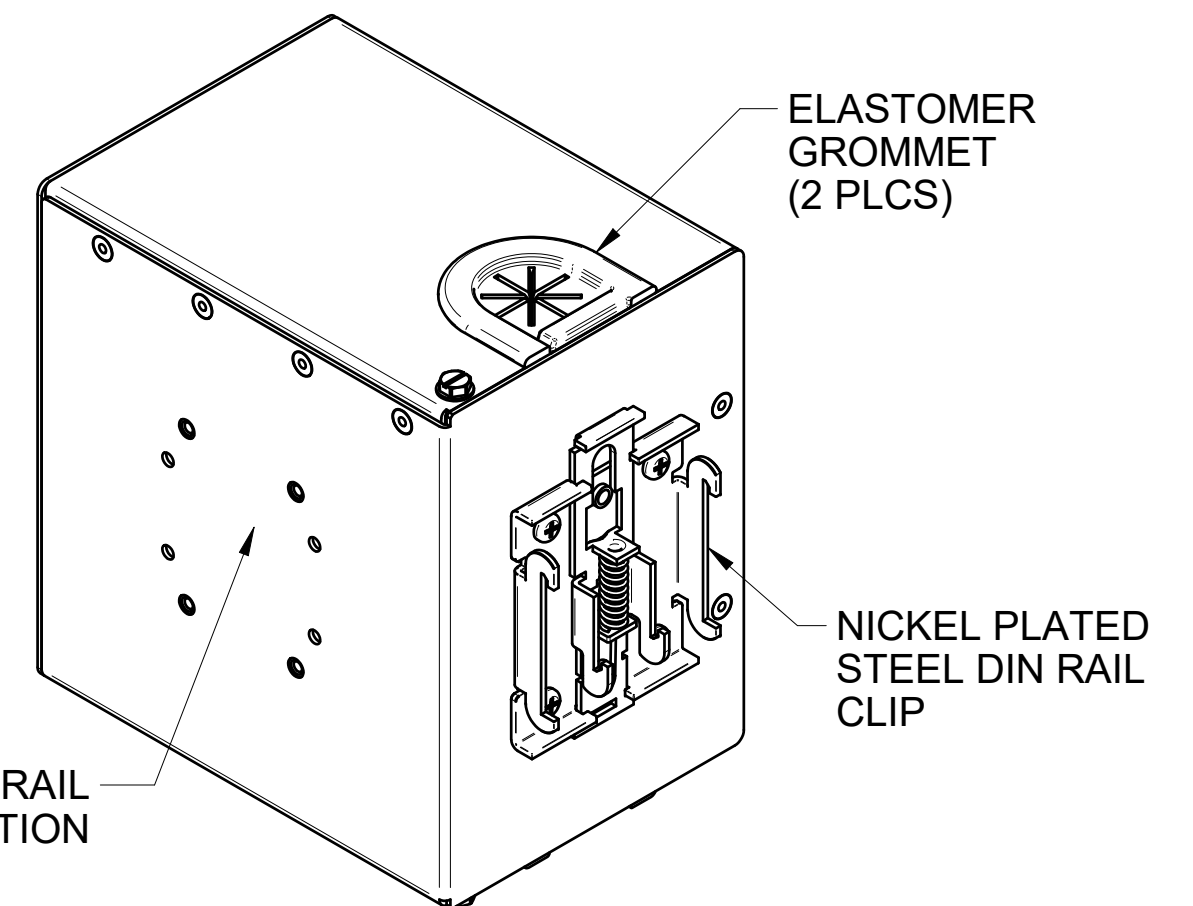

REAR ISOMETRIC VIEW

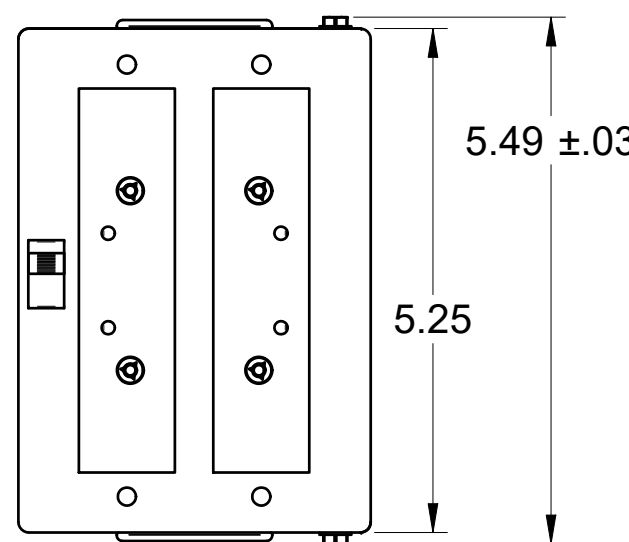

FRONT VIEW

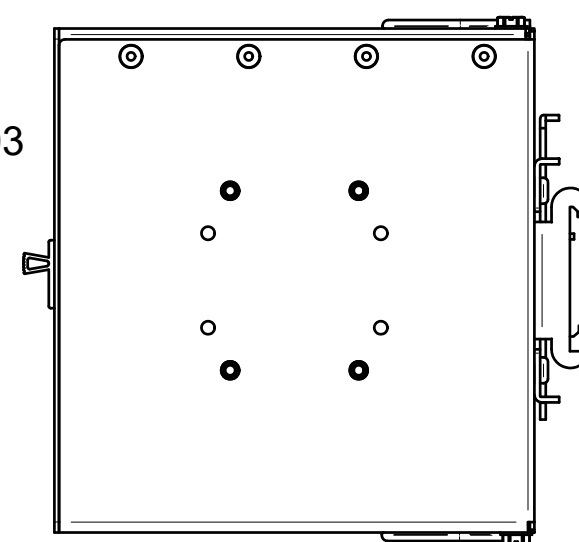

RIGHT SIDE VIEW

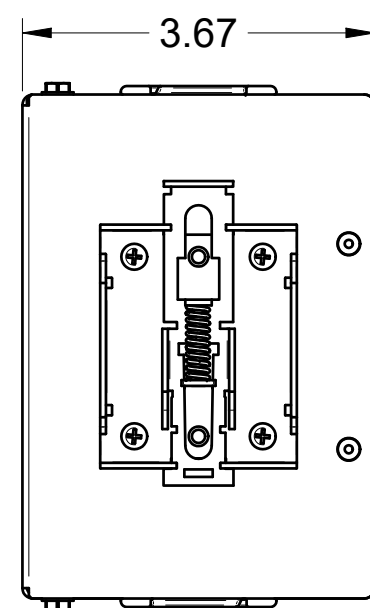

REAR VIEW

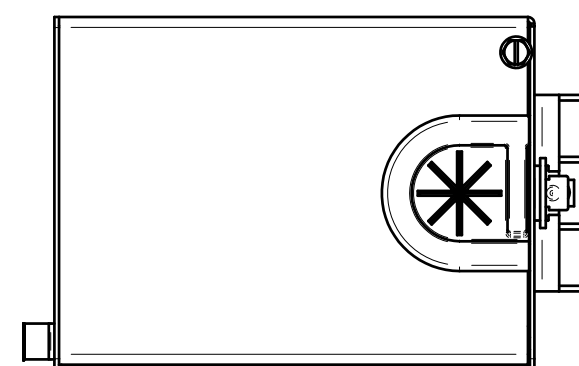

BOTTOM VIEW

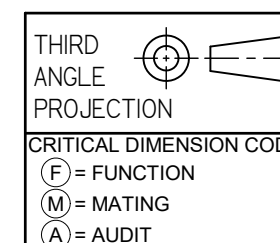

DTC2AP	CABINET, DIN RAIL, 2 ADPTR PLT, BLK, GROMMETS
OCC PART NO.	DESCRIPTION
UNLESS OTHERWISE SPECIFIED DIMENSIONS ARE IN INCHES. TOLERANCES: FRACTIONS ±1/16" 2 PLACE DECIMALS ±.02"	THIS DRAWING AND THE DESIGN SHOWN ARE THE PROPERTY OF OPTICAL CABLE CORPORATION AND MAY NOT BE USED AS THE BASIS FOR MANUFACTURE OR SALE WITHOUT SPECIFIC WRITTEN PERMISSION OF OPTICAL CABLE CORPORATION.
DRAWN D.A.HOLBERT	DATE 5/15/12
CHECKED J.HOWE	DATE 12/16/12
ENGINEER J.YANIK	DATE 5/15/12
APPROVED J.HOWE	DATE 6/19/12
PREVIOUS DWG	
NEXT DWG	FILENAME C111247E.dft
	SCALE: NONE SHEET 1 OF 1

OCC
 OPTICAL CABLE CORPORATION
 33 Superior Way
 Swannanoa, NC 28778
 Phone: 828-298-2260
 Fax: 828-298-2487
 www.occfiber.com

DWG TITLE: DIN RAIL ENCLOSURE, 2 ADAPTER PLATE, WITH GROMMETS

SIZE: C DWG NO. **C111247** REV E