

| REVISION HISTORY | | | | |
|------------------|-----|-------------|---------|---------|
| REV | SHT | DESCRIPTION | DATE | CHECKED |
| A | ALL | RELEASE NEW | 9/18/15 | JH |

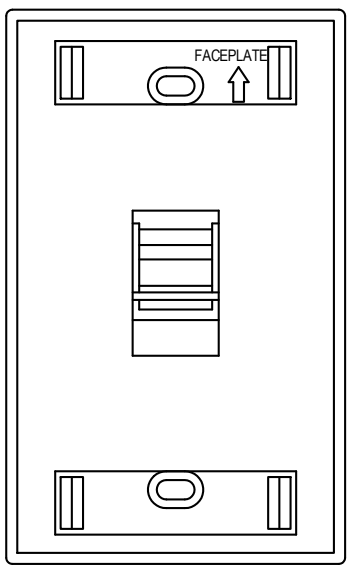

"OPTICAL CABLE CORPORATION (OCC) RESERVES THE RIGHT TO REVISE ANY AND ALL DRAWING SPECIFICATIONS."

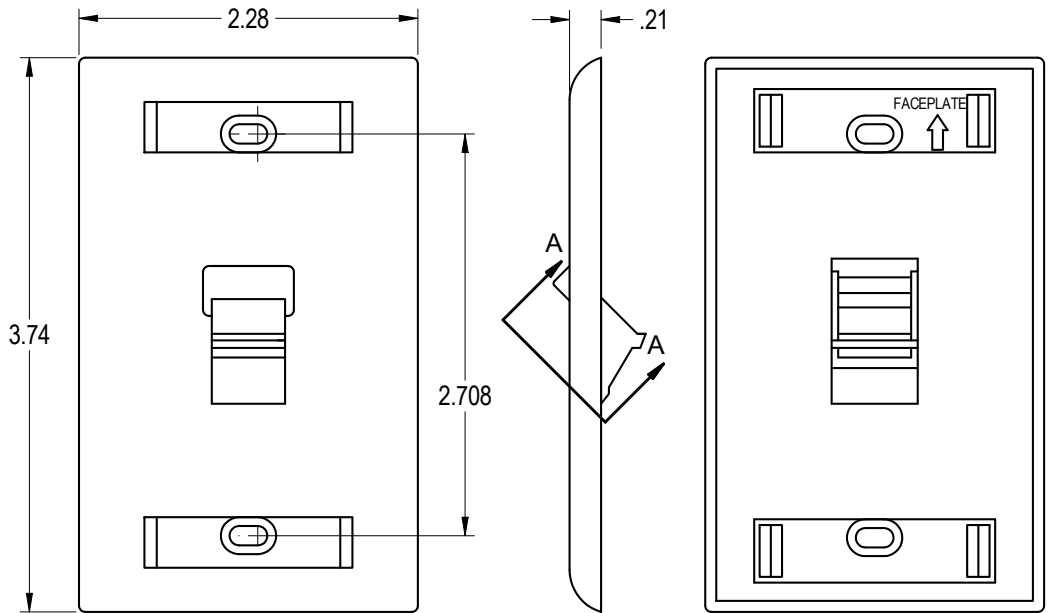
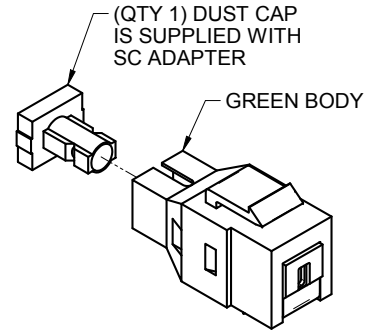
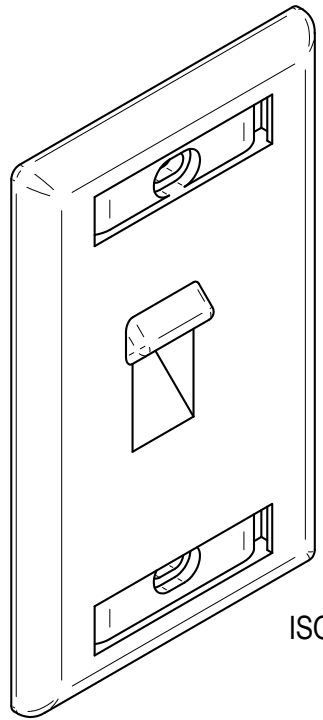

ISOMETRIC (EXPLODED)

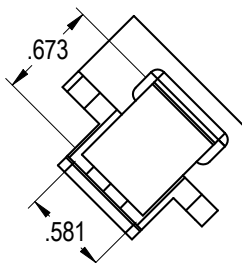

SECTION A-A

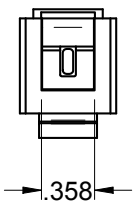
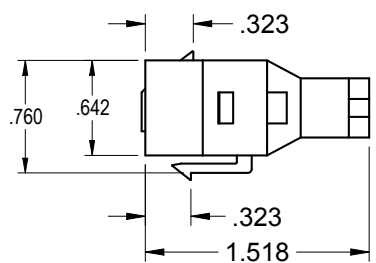
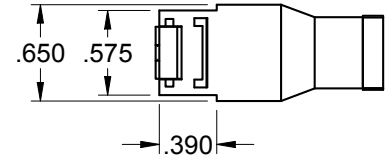

| | |
|-----------------|--|
| FPSK01ASCAS"CC" | KIT, FACEPLATE, SNGL GANG, KMJ X 1, ANGLED, "COLOR", WITH SHUTTERED SC ADAPTER |
| OCC PART NO. | DESCRIPTION |

- NOTES: UNLESS OTHERWISE SPECIFIED.
- INCLUDES A HARDWARE KIT (2 ea. SCREWS) #6-32 X 7/8", PAINTED PER "COLOR".
 - "CC" IN PART# DESIGNATES FACEPLATE "COLOR".

| SUFFIX | COLOR CODE |
|--------|--------------|
| 00 | ELEC. IVORY |
| 01 | OFFICE WHITE |
| 12 | BRIGHT WHITE |

UNCONTROLLED COPY

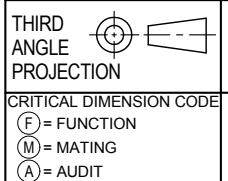

| | |
|---|--|
| UNCONTROLLED COPY | |
| UNLESS OTHERWISE SPECIFIED DIMENSIONS ARE IN INCHES. TOLERANCES: FRACTIONS ±1/32" ANGLES ±1/2° 3 PLACE DECIMALS ±.005" 2 PLACE DECIMALS ±.01" | THIS DRAWING AND THE DESIGN SHOWN ARE THE PROPERTY OF OPTICAL CABLE CORPORATION AND MAY NOT BE USED AS THE BASIS FOR MANUFACTURE OR SALE WITHOUT SPECIFIC WRITTEN PERMISSION OF OPTICAL CABLE CORPORATION. |
| MATERIAL SEE BILL OF MATERIAL | FINISH SEE NOTES |
| DRAWN D.A.HOLBERT | DATE 9/18/15 |
| CHECKED S.PORACH | DATE 9/19/15 |
| ENGINEER J.YANIK | DATE 9/18/15 |
| APPROVED J.HOWE | DATE 9/19/15 |
| PREVIOUS DWG | |
| NEXT DWG | FILENAME C112138A.dft |

5290 Concourse Drive
Roanoke, VA 24019
Phone: 800-622-7711
Fax: 540-265-0724
www.occfiber.com

| | | | |
|-----------|----------------|--|--------|
| DWG TITLE | | CUSTOMER DRAWING, FACEPLATE KIT, 1PORT, ANGLED, WITH SHUTTERED SC INSERT | |
| SIZE | DWG NO. | REV | |
| B | C112138 | A | |
| SCALE: | NONE | SHEET | 1 OF 1 |