

REV		SHT	DESCRIPTION	DATE	ECN	CHECKED
A	ALL	RELEASE	NEW	7/11/01	NEW	RBS



Blue White	1 R	T26	White Blue
Orange White	2 R	T27	White Orange
Green White	3 R	T28	White Green
Brown White	4 R	T29	White Brown
Slate White	5 R	T30	White Slate
Blue Red	6 R	T31	Red Blue
Orange Red	7 R	T32	Red Orange
Green Red	8 R	T33	Red Green
Brown Red	9 R	T34	Red Brown
Slate Red	10 R	T35	Red Slate
Blue Black	11 R	T36	Black Blue
Orange Black	12 R	T37	Black Orange
Green Black	13 R	T38	Black Green
Brown Black	14 R	T39	Black Brown
Slate Black	15 R	T40	Black Slate
Blue Yellow	16 R	T41	Yellow Blue
Orange Yellow	17 R	T42	Yellow Orange
Green Yellow	18 R	T43	Yellow Green
Brown Yellow	19 R	T44	Yellow Brown
Slate Yellow	20 R	T45	Yellow Slate
Blue Violet	21 R	T46	Violet Blue
Orange Violet	22 R	T47	Violet Orange
Green Violet	23 R	T48	Violet Green
Brown Violet	24 R	T49	Violet Brown
Slate Violet	25 R	T50	Violet Slate

**PAIR COLORS**  
 Pair #1 Blue  
 Pair #2 Orange  
 Pair #3 Green  
 Pair #4 Brown  
 Pair #5 Slate

**BAND COLORS**  
 White  
 Red  
 Black  
 Yellow  
 Violet

T-R=Tip-Ring

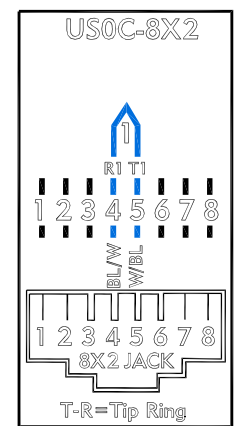
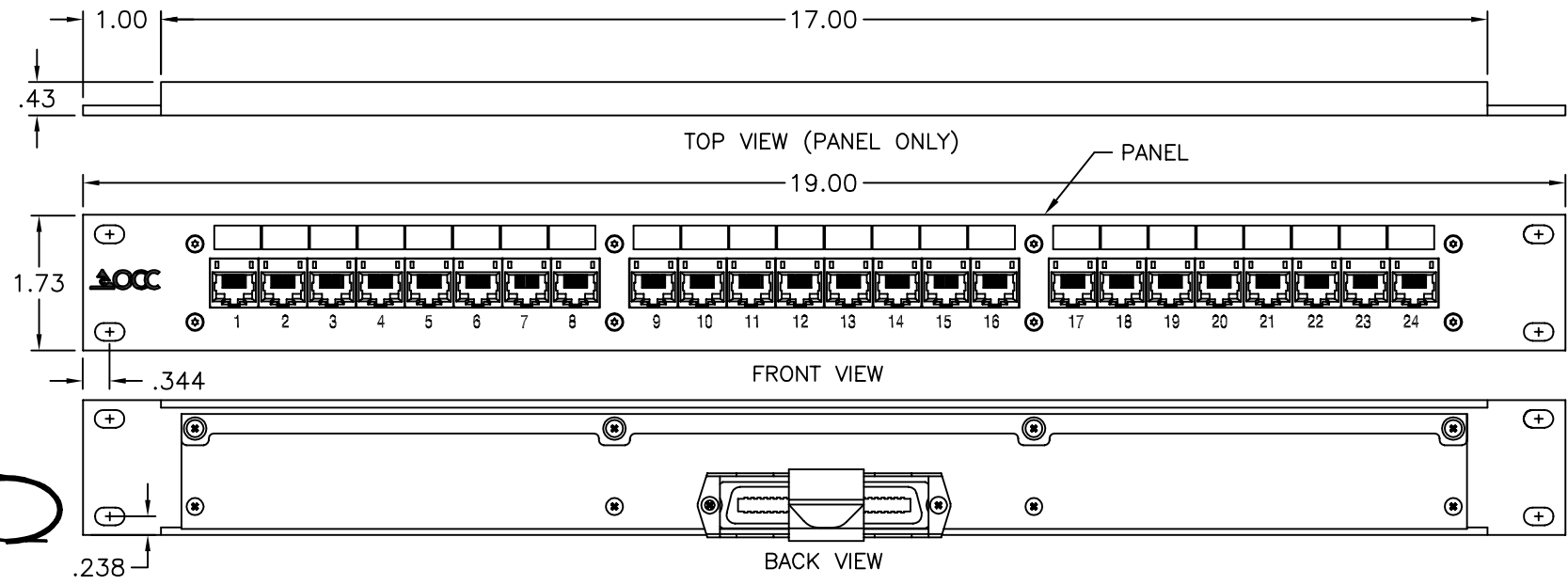
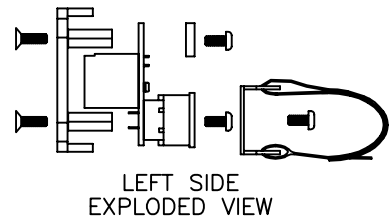

**SPECIFICATIONS**

**APPLICATION SUPPORT LIST:**

- SUPPORTS VOICE

**FEATURES/MATERIALS:**

- CONSTRUCTED OF EXTRUDED AIRCRAFT GRADE BLACK ANODIZED ALUMINUM OR COLD ROLLED STEEL, DIMENSIONS AND MOUNTING HOLES PER EIA-310-D.
- ALL PLASTIC COMPONENTS ARE HIGH IMPACT SELF-EXTINGUISHING RATED 94V-0.
- CIRCUIT BOARD MATERIALS ARE FIBERGLASS/EPOXY FR-4 SOLDER MASKED ON BOTH SIDES.
- MODULAR JACK CONTACTS ARE HIGH-STRENGTH PHOSPHOR BRONZE OR BECU ALLOY WITH 50 MICRO-INCHES OF GOLD OVER 100 MICRO-INCHES OF NICKEL (OR EQUIVALENT AU/PD/NI PROCESS)
- UL LISTED.
- CSA CERTIFIED.
- 110 IDC CONTACTS ARE PHOSPHOR BRONZE PLATED WITH TIN, AND FIRE-RETARDANT PLASTIC.
- MODULAR JACK MEETS OR EXCEEDS ISO/IEC 60603-7 CLASS A.

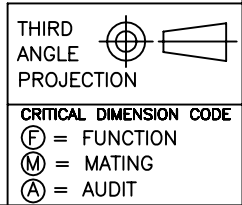

DCC2482/2502	PATCH PANEL, 24P, 8 POS, 2 WIRE, TELCO, USOC
OCC PART NO.	DESCRIPTION

<b>UNCONTROLLED COPY</b>			5290 Concourse Drive Roanoke, VA 24019 Phone: 800-622-7711 Fax: 540-265-0724 www.occfiber.com	
UNLESS OTHERWISE SPECIFIED DIMENSIONS ARE IN INCHES TOLERANCES: FRACTIONS ±1/32" ANGLES ±1/2" 3 PLACE DECIMALS ±.005" 2 PLACE DECIMALS ±.01"	THIS DRAWING AND THE DESIGN SHOWN ARE THE PROPERTY OF OPTICAL CABLE CORPORATION AND MAY NOT BE USED AS THE BASIS FOR MANUFACTURE OR SALE WITHOUT SPECIFIC WRITTEN PERMISSION OF OPTICAL CABLE CORPORATION.		DWG TITLE <b>PATCH PANEL ASSEMBLY, 24 PORT, 8 POS, TELCO, 2 WIRE, USOC</b>	
DRAWN BY D.A.HOLBERT	DATE 7/11/01	SIZE <b>B</b>	DWG NO. <b>C103260</b>	REV <b>A</b>
CHECKED BY R.B.SMITH	DATE 11/21/01	SCALE NONE	SHEET 1 OF 1	
ENGINEER J.YANIK	DATE 7/11/01	FILENAME C103260A.DWG		
APPROVED H.JOHNSON	DATE 10/1/10			
PREVIOUS DWG				
NEXT DWG				