

1X32 Cassette Front View

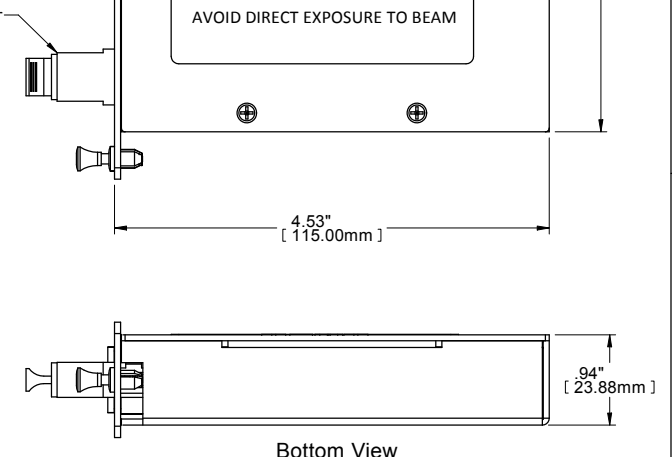

Bottom View

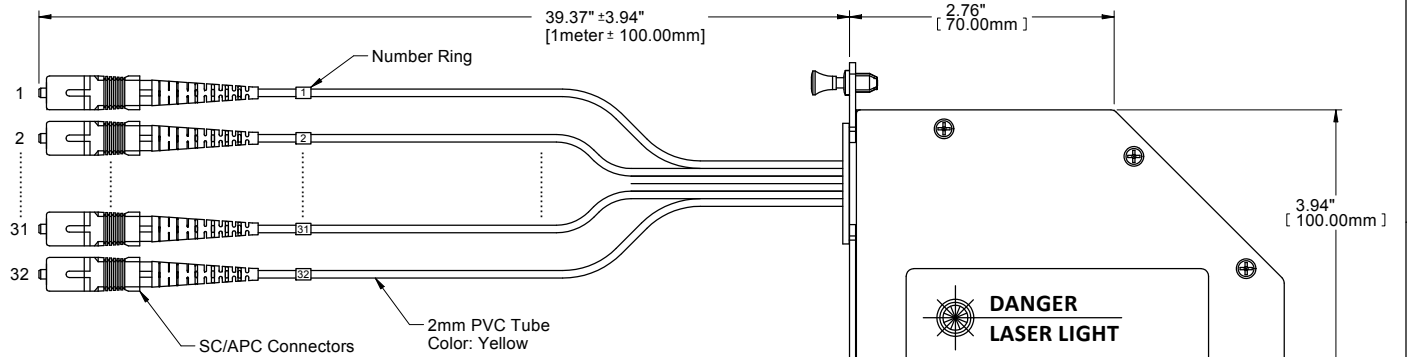
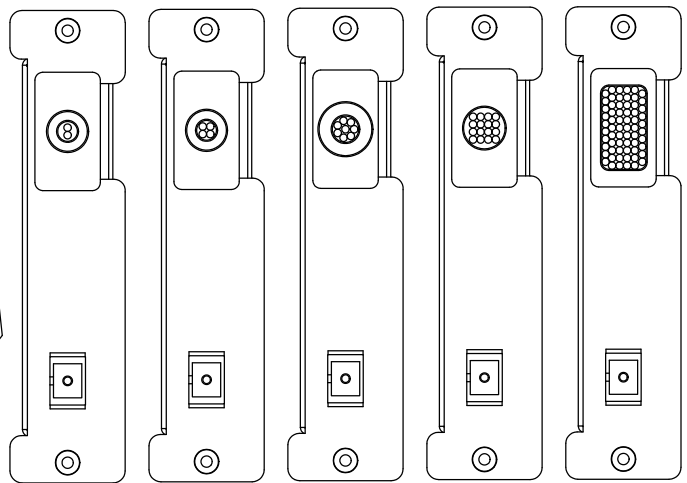

1X2 Cassette 1X4 Cassette 1X8 Cassette 1X16 Cassette 1X64 Cassette Front View

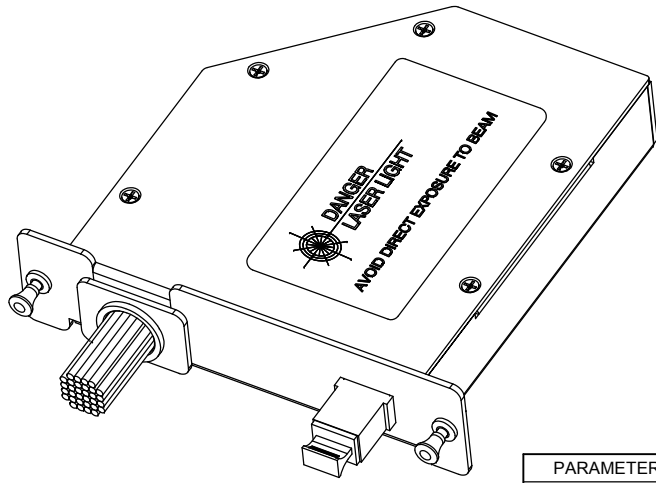

1x32 Splitter Shown

PARAMETERS	1X2	1X4	1X8	1X16	1X32	1X64
OPERATING WAVELENGTH (nm)	1260nm to 1650nm					
INSERTION LOSS maximum (dB)	4.5	7.9	11.2	14.2	17.5	21.5
UNIFORMITY (dB)	0.6	0.8	1.0	1.4	1.7	2.7
PDL maximum (dB)	0.2	0.2	0.3	0.3	0.3	0.4
RETURN LOSS maximum (dB)	55dB					
OPERATING TEMP. (°C)	-40°C to +85°C					

PONC1X64SCAPC2	CASSETTE MODULE, POL SPLITTER w/2mm PIGTAILS, 1 X 64, SM, SCAPC
PONC1X32SCAPC2	CASSETTE MODULE, POL SPLITTER w/2mm PIGTAILS, 1 X 32, SM, SCAPC
PONC1X16SCAPC2	CASSETTE MODULE, POL SPLITTER w/2mm PIGTAILS, 1 X 16, SM, SCAPC
PONC1X8SCAPC2	CASSETTE MODULE, POL SPLITTER w/2mm PIGTAILS, 1 X 8, SM, SCAPC
PONC1X4SCAPC2	CASSETTE MODULE, POL SPLITTER w/2mm PIGTAILS, 1 X 4, SM, SCAPC
PONC1X2SCAPC2	CASSETTE MODULE, POL SPLITTER w/2mm PIGTAILS, 1 X 2, SM, SCAPC
OCC PART NUMBER	DESCRIPTION

UNLESS OTHERWISE SPECIFIED, THIS DRAWING AND THE DESIGN SHOWN ARE THE PROPERTY OF OPTICAL CABLE CORPORATION AND TOLERANCES: FRACTIONS ±1/32 ANGLES ±1/2° 3 PLACE DECIMALS ±.015" 2 PLACE DECIMALS ±.03"	
CHECKED J.HOWE	DATE 12/18/17
ENGINEER J.YANIK	DATE 12/14/14
APPROVED J.CALLOWAY	DATE 5/22/18
PREVIOUS DWG	
NEXT DWG	

OCC
OPTICAL CABLE CORPORATION

33 Superior Way
Swannanoa, NC 28778
Phone: 828-298-2260
Fax: 828-298-2487
www.occfiber.com

DWG TITLE: CASSETTE ASSY, ANGLED, PONC, 8-64 FIBER, SM, SCAPC

SIZE: C DWG NO. **C113010** REV B

SCALE: NONE SHEET 1 OF 1

"OPTICAL CABLE CORPORATION (OCC) RESERVES THE RIGHT TO REVISE ANY AND ALL DESIGN SPECIFICATIONS."
UNCONTROLLED COPY

